

ZERUN

CATALOGUE

Anhui Zerun Optoelectronic Co., Ltd
No.777, Hudong South Road, Ma-anshan, Anhui, China, 243000
www.zr-led.com





Anhui Zerun Optoelectronic Co., Ltd is one of the largest LED manufacturers which is specialized in LED panel lights. It is registered in Ma-anshan Economic and Technical Development Zone in 2008. It has more than 300 employees currently with independent property rights of the production workshop 40,000 square meters.

Nowadays, Zerun only focus on LED panel lights, turning out 200,000 to 300,000 pcs LED panel lights per month. Annual turnover more than 4,000,000 production capacity. Our panels get full TUV GS CE RoHS New ErP SAA certifications. Our factory has been accredited with ISO 9001:2015. Additionally, with well equipped LED lab, complete SMT lines, IES test room and fully automatic aging machines, we can deliver LED panel lights in time. For more information please contact us freely or mail to us: sales@zr-led.com.

CONTENTS



COMMERCIAL LIGHTING

- ◆ Edge-lit Series
- ◆ Backlit Series
- ◆ Frame Series

SMART HOME LIGHTING

- ◆ Ceiling Lamp

COMMERCIAL LIGHTING

Edge-lit Series

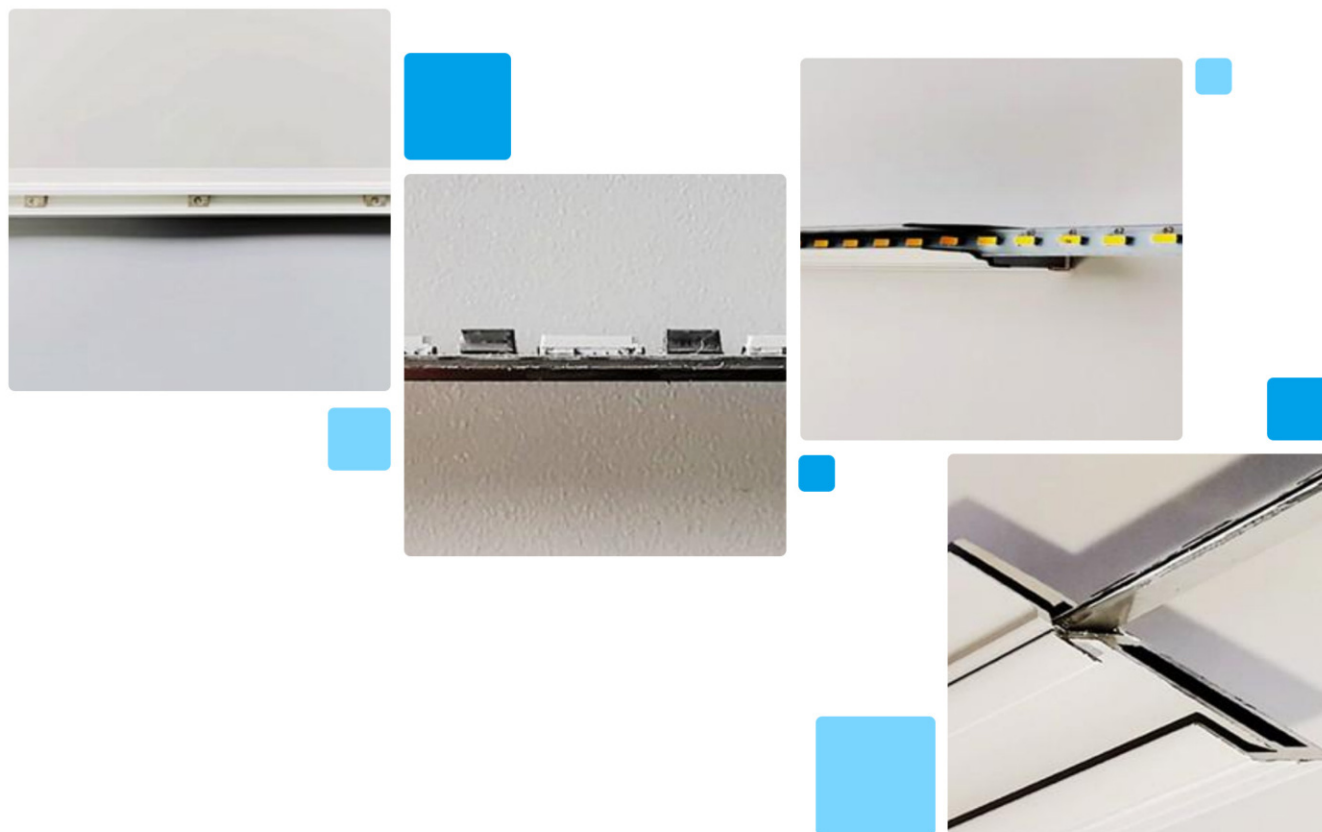

MERITS OF ZERUN EDGE-LIT SERIES

1

Slideable Nuts on Rear Panel---Easier Installation.

2

Blocks on Each PCB Strip---Well Protect the LED Beads from Damage due to Volume Expansion of Light Guide Plate.

3

No Adhesive Tapes on Each PCB Strip.

4

Excellent Heat Dissipation.

5

*4pcs L-Shaped Steel Corners Inside -- Pretty Tight Aluminum Panel Frames and Strong Panel Body.

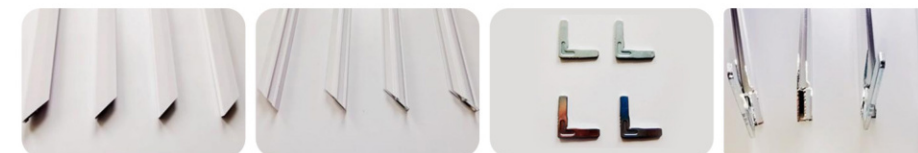

PROFESSIONAL

- (1) 10mm Thickness Panel Body ---- Heavier Aluminum Frame with Pretty Strong Panel Body
- (2) 2.0mm Thickness PMMA Light Guide Plate(LGP) ---Thick and Strong Enough

Type	Regular Sizes	Wattage	Efficiency (LM/W)	Input Volts	PF	Frame	Diffuser	LGP	CRI	Single CCT Optional	SDCM	IP Rating	LED Lifespan
Indoor	295x295x10mm	18W	85-100	AC220-240V	> 0.95	Aluminum	PS	2.0mm PMMA	>80	3000K-6500K	< 6	40	50,000Hrs
Indoor	295x595x10mm	22W	90-120	AC220-240V	> 0.95	Aluminum	PS	2.0mm PMMA	>80	3000K-6500K	< 6	40	50,000Hrs
Indoor	595x595x10mm	40W	90-125	AC220-240V	> 0.95	Aluminum	PS	2.0mm PMMA	>80	3000K-6500K	< 6	40	50,000Hrs
Indoor	295x1195x10mm	40W	90-125	AC220-240V	> 0.95	Aluminum	PS	2.0mm PMMA	>80	3000K-6500K	< 6	40	50,000Hrs
Indoor	595x1195x10mm	60W	90-125	AC220-240V	> 0.95	Aluminum	PS	2.0mm PMMA	>80	3000K-6500K	< 6	40	50,000Hrs
Indoor	600x600x10mm	40W	90-125	AC220-240V	> 0.95	Aluminum	PS	2.0mm PMMA	>80	3000K-6500K	< 6	40	50,000Hrs
Indoor	620x620x10mm	40W	90-125	AC220-240V	> 0.95	Aluminum	PS	2.0mm PMMA	>80	3000K-6500K	< 6	40	50,000Hrs

*Customized sizes are available but MOQ is needed.

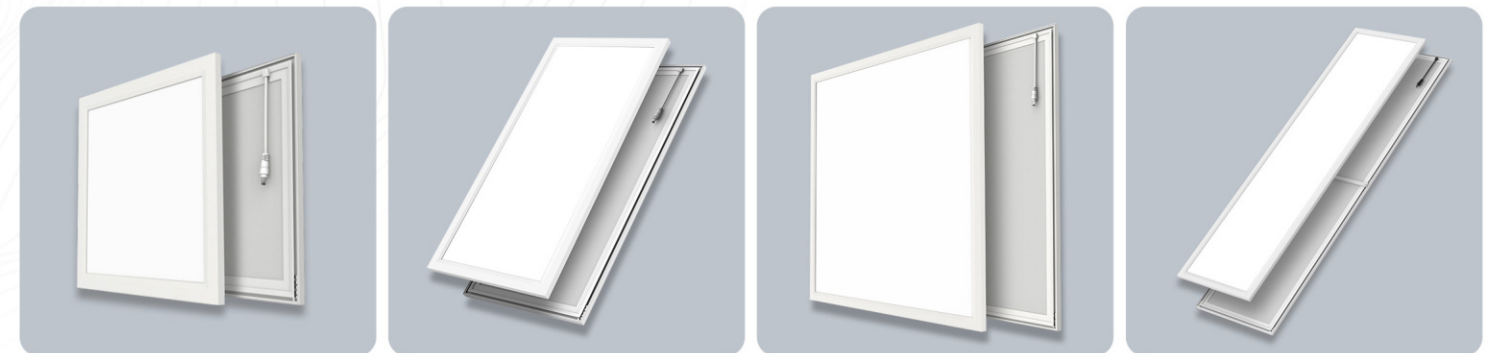

- ① L-shaped Holder
- ② Diffuser
- ③ Light Guide Plate
- ④ Reflective Paper
- ⑤ Back Plate
- ⑥ Aluminum Frame
- ⑦ PCB Strip

ECONOMIC

- (1) 8mm Thickness Panel Body -- Slimmer Aluminum Frame but Cheaper
- (2) 1.8mm Thickness PMMA Light Guide Plate(LGP) --- Slimmer but still good

Type	Regular Sizes	Wattage	Efficiency (LM/W)	Input Volts	PF	Frame	Diffuser	LGP	CRI	Single CCT Optional	SDCM	IP Rating	LED Lifespan
Indoor	595x595x8mm	40W	90-125	AC220-240V	> 0.95	Aluminum	PS	1.8mm PMMA	>80	3000K-6500K	< 6	40	50,000Hrs
Indoor	295x1195x8mm	40W	90-125	AC220-240V	> 0.95	Aluminum	PS	1.8mm PMMA	>80	3000K-6500K	< 6	40	50,000Hrs

*Customized sizes are available but MOQ is needed.



WATERPROOF

- (1) For waterproof panels, ZERUN can produce the panels with IP65 and IP44/54 currently.
- (2) Panels with Mirror Surface Diffuser to Guarantee Waterproof Function.
- (3) For IP65 Panels, the whole panel is IP65, not front panel IP65 only.
- (4) For IP44/54 panels, two versions are available. One is the whole panel IP44/54 and another is front panel IP44/54 but rear panel IP40 to get less production costs.
- (5) Neither IP65 nor IP44/54 panels can be with high lumens due to it' s panel body airtightness. High lumens means high heat and airtightness means poor dissipation, so the heat could shorten the lifespan of LED beads.

Type	Regular Sizes	Wattage	Efficiency (LM/W)	Input Volts	PF	Frame	Diffuser	LGP	CRI	Single CCT Optional	SDCM	IP Rating	LED Lifespan
Indoor	595x595x10mm	40W	90-115	AC220-240V	> 0.95	Aluminum	PS/PC	2.0mm PMMA	>80	3000K-6500K	< 6	65	50,000Hrs
Indoor	595x595x10mm	40W	90-115	AC220-240V	> 0.95	Aluminum	PS/PC	2.0mm PMMA	>80	3000K-6500K	< 6	44/54	50,000Hrs
Indoor	295x1195x10mm	40W	90-115	AC220-240V	> 0.95	Aluminum	PS/PC	2.0mm PMMA	>80	3000K-6500K	< 6	44/54	50,000Hrs
Indoor	595x1195x10mm	60W	90-115	AC220-240V	> 0.95	Aluminum	PS/PC	2.0mm PMMA	>80	3000K-6500K	< 6	44/54	50,000Hrs
Indoor	600x600x10mm	40W	90-115	AC220-240V	> 0.95	Aluminum	PS/PC	2.0mm PMMA	>80	3000K-6500K	< 6	44/54	50,000Hrs
Indoor	620x620x10mm	40W	90-115	AC220-240V	> 0.95	Aluminum	PS/PC	2.0mm PMMA	>80	3000K-6500K	< 6	44/54	50,000Hrs

* Customized sizes for IP44/54 are available but MOQ is needed.

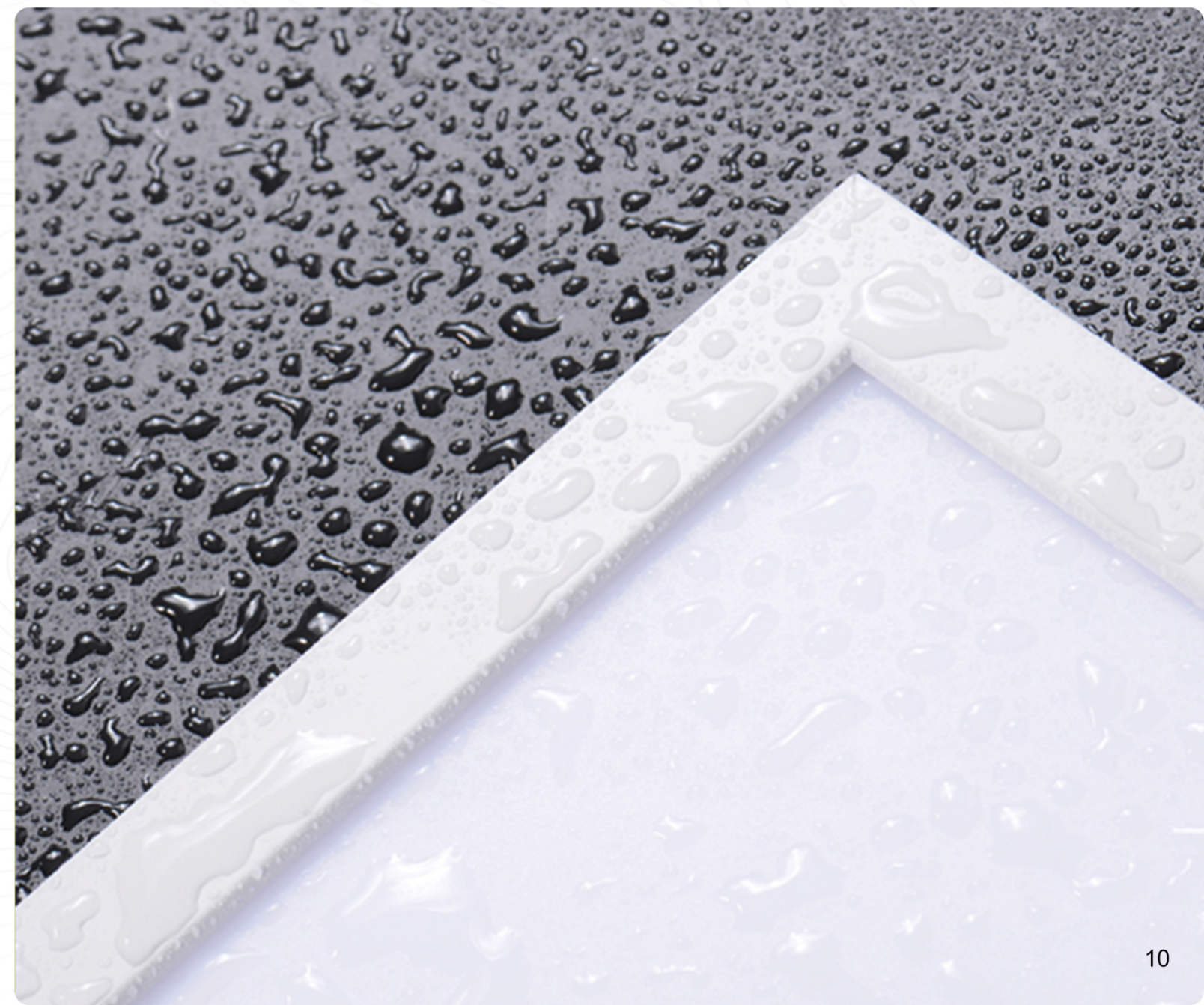

CCT TUNABLE

(1) 3 CCT Panel with Dial Switch

The pic below shows there are 3 gears on dial switch and we can easily choose the CCT we prefer by switching.

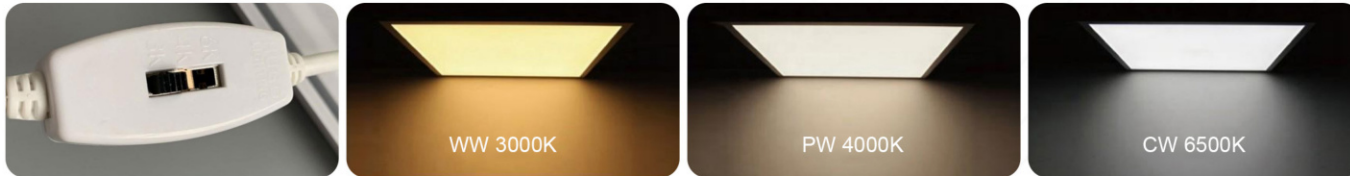

(2) 3 CCT Panel with Two Pairs of Connectors

The pic below shows there are two pairs of male and female connectors on panel. The pic below well illustrates how we could switch the CCT we prefer.

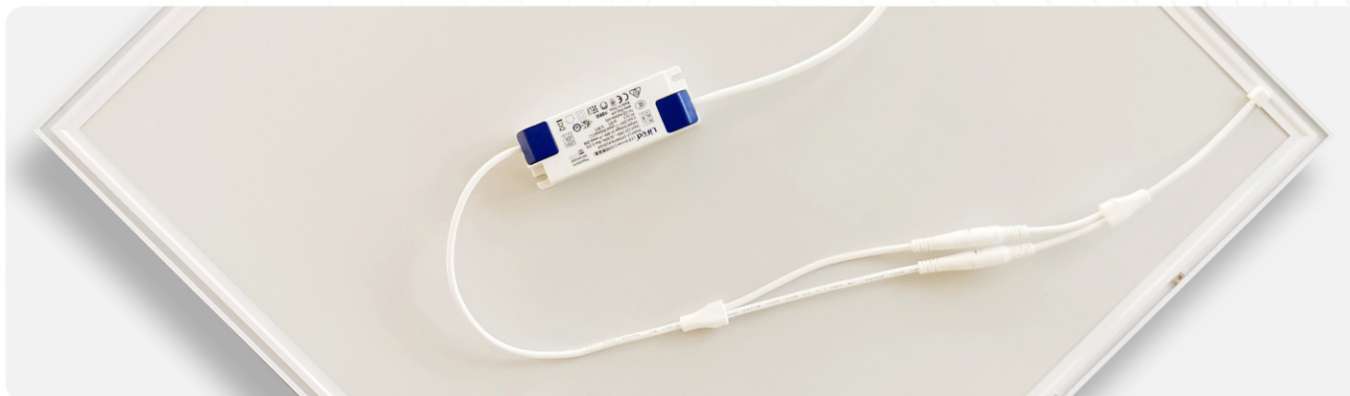

(3) CCT Panel with Remote Control

The pic below shows a 2.4G LED Driver with its matched remote control. CCT tunable and Dimmable functions are well combined on the remote control version.



Type	Regular Sizes	Wattage	Efficiency (LM/W)	Input Volts	PF	Frame	Diffuser	LGP	CRI	3 CCT Switchable	Remote Version	SDCM	IP Rating	LED Lifespan
Indoor	595x595x10mm	36W	85 Single CCT 100 Mixed MAX	AC220-240V	> 0.95	Aluminum	PS	2.0mm PMMA	>80	3000K 4000K 6500K	3000K - 6500K	< 6	40	50,000Hrs
Indoor	295x1195x10mm	36W	85 Single CCT 100 Mixed MAX	AC220-240V	> 0.95	Aluminum	PS	2.0mm PMMA	>80	3000K 4000K 6500K	3000K - 6500K	< 6	40	50,000Hrs
Indoor	620x620x10mm	36W	85 Single CCT 100 Mixed MAX	AC220-240V	> 0.95	Aluminum	PS	2.0mm PMMA	>80	3000K 4000K 6500K	3000K - 6500K	< 6	40	50,000Hrs
Indoor	595x1195x10mm	52W	85 Single CCT 100 Mixed MAX	AC220-240V	> 0.95	Aluminum	PS	2.0mm PMMA	>80	3000K 4000K 6500K	3000K - 6500K	< 6	40	50,000Hrs

* Customized sizes are available but MOQ is needed.

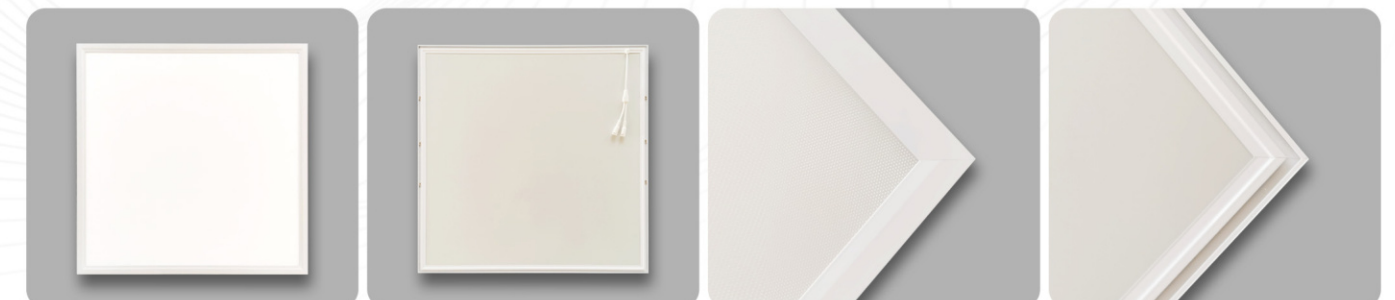

HIGH LUMENS PER WATT

Just as its name implies, this item is with high lumens per watt. For this item, it could reach about 140LM/W that high. But how could we make it? Some small springs are added into the bottom of the LED strips, so LED beads can always fit tightly to the light guide plate (LGP) due to its elastic structure. That' s the reason why it could reach about 140LM/W that high.



Type	Regular Sizes	Wattage	Efficiency (LM/W)	Input Volts	PF	Frame	Diffuser	LGP	CRI	Single CCT Optional	SDCM	IP Rating	LED Lifespan
Indoor	595x595x10mm	24W	140 MAX	AC220-240V	> 0.95	Aluminum	PS	2.0mm PMMA	>80	3000K-6500K	< 6	40	50,000Hrs

* Customized sizes are available but MOQ is needed.



DIRECT SURFACE MOUNT

Just as its name implies, no need extra ceiling mounting frames if you wanna the panels are surface mounted. Now there are two versions available.

(1) X3 Series

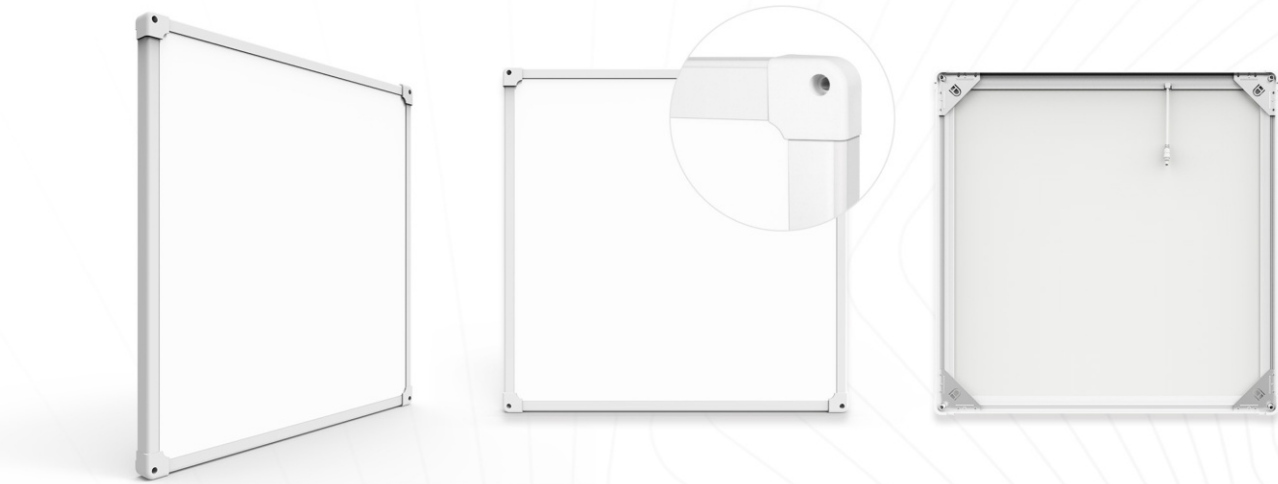

Type	Regular Sizes	Wattage	Efficiency (LM/W)	Input Volts	PF	Frame	Diffuser	LGP	CRI	Single CCT Optional	SDCM	IP Rating	LED Lifespan
Indoor	295x595x24mm	20W	85-100	AC220-240V	> 0.95	Aluminum	PS	2.0mm PMMA	>80	3000K-6500K	< 6	40	50,000Hrs
Indoor	595x595x24mm	40W	85-115	AC220-240V	> 0.95	Aluminum	PS	2.0mm PMMA	>80	3000K-6500K	< 6	40	50,000Hrs
Indoor	295x1195x24mm	40W	85-115	AC220-240V	> 0.95	Aluminum	PS	2.0mm PMMA	>80	3000K-6500K	< 6	40	50,000Hrs
Indoor	620x620x24mm	40W	85-115	AC220-240V	> 0.95	Aluminum	PS	2.0mm PMMA	>80	3000K-6500K	< 6	40	50,000Hrs

* Customized sizes are available but MOQ is needed.

(2) X7 Series

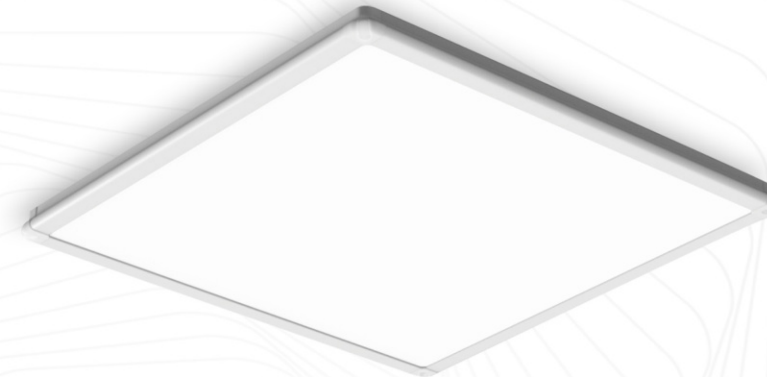

Both versions are directly surface mounted and no need extra ceiling mounting frames. However, X3 series need ultra thin LED drivers to well match the panel thickness due to its ultra thin structure. To well improve this, X7 Series make up for the deficiency in this aspect. For X7 series, a standard LED driver with about 30mm thickness can well match.

Type	Regular Sizes	Wattage	Efficiency (LM/W)	Input Volts	PF	Frame	Diffuser	LGP	CRI	Single CCT Optional	SDCM	IP Rating	LED Lifespan
Indoor	295x295x37mm	20W	85-100	AC220-240V	> 0.95	Aluminum	PS	2.0mm PMMA	>80	3000K-6500K	< 6	40	50,000Hrs
Indoor	595x595x37mm	40W	85-120	AC220-240V	> 0.95	Aluminum	PS	2.0mm PMMA	>80	3000K-6500K	< 6	40	50,000Hrs
Indoor	295x1195x37mm	40W	85-120	AC220-240V	> 0.95	Aluminum	PS	2.0mm PMMA	>80	3000K-6500K	< 6	40	50,000Hrs

* Customized sizes are available but MOQ is needed.

SENSOR PANELS

For sensor panels, we use sensor drivers with ZERUN regular panels to achieve the daylight harvesting and motion functions.



INNOVATIVE

Just as its name implies, these items are different from our regular ones with some innovation.

(1) Double Side Emitting

The item is a edge-lit LED panel with double side emitting. For example, 30% brightness for upper side and 70% brightness for inferior side.

(2) Square Panel Size but with Round Luminous Surface

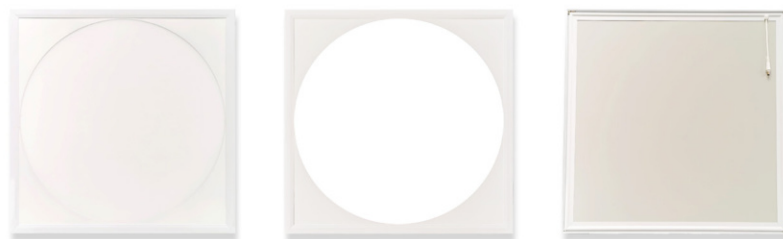

(3) Advertising Light

This is our new item with ZERUN unique design. The aluminum frames can be opened externally due to its unique structure, so the advertising picture inside can be easily replaced.



SMALLER

Just as its name implies, these items are with smaller sizes regardless of round or square.
There are four versions for these smaller items.

(1) Surface Round

Model	Diameter (MM)	Hole (MM)	Wattage +/-5%	Efficiency (LM/W)	Diffuser	LGP	Frame	CRI	PF	SDCM	IP Rating	Warranty
ZR-PL120SR-6W	Ø120		6W	60	PS	3.0mm Laser PMMA	Aluminum	>80	>0.5	<6	20/44	5 Years
ZR-PL170SR-12W	Ø170		12W	80	PS	3.0mm Laser PMMA	Aluminum	>80	>0.5	<6	20/44	5 Years
ZR-PL225SR-18W	Ø225		18W	90	PS	3.0mm Laser PMMA	Aluminum	>80	>0.9	<6	20/44	5 Years
ZR-PL300SR-24W	Ø300		24W	90	PS	3.0mm Laser PMMA	Aluminum	>80	>0.9	<6	20/44	5 Years

(2) Surface Square

Model	Diameter (MM)	Hole (MM)	Wattage +/-5%	Efficiency (LM/W)	Diffuser	LGP	Frame	CRI	PF	SDCM	IP Rating	Warranty
ZR-PL120SS-6W	120*120		6W	60	PS	3.0mm Laser PMMA	Aluminum	>80	>0.5	<6	20/44	5 Years
ZR-PL170SS-12W	170*170		12W	80	PS	3.0mm Laser PMMA	Aluminum	>80	>0.5	<6	20/44	5 Years
ZR-PL225SS-18W	225*225		18W	90	PS	3.0mm Laser PMMA	Aluminum	>80	>0.9	<6	20/44	5 Years
ZR-PL300SS-24W	300*300		24W	90	PS	3.0mm Laser PMMA	Aluminum	>80	>0.9	<6	20/44	5 Years

(3) Recessed Round

Model	Diameter (MM)	Hole (MM)	Wattage +/-5%	Efficiency (LM/W)	Diffuser	LGP	Frame	CRI	PF	SDCM	IP Rating	Warranty
ZR-PL120RR-6W	Ø120	Ø105	6W	60	PS	3.0mm Laser PMMA	Aluminum	>80	>0.5	<6	20/44	5 Years
ZR-PL150RR-9W	Ø150	Ø130	9W	75	PS	3.0mm Laser PMMA	Aluminum	>80	>0.5	<6	20/44	5 Years
ZR-PL170RR-12W	Ø175	Ø155	12W	80	PS	3.0mm Laser PMMA	Aluminum	>80	>0.5	<6	20/44	5 Years
ZR-PL190RR-15W	Ø195	Ø175	15W	85	PS	3.0mm Laser PMMA	Aluminum	>80	>0.9	<6	20/44	5 Years
ZR-PL225RR-18W	Ø225	Ø205	18W	90	PS	3.0mm Laser PMMA	Aluminum	>80	>0.9	<6	20/44	5 Years
ZR-PL300RR-24W	Ø300	Ø280	24W	90	PS	3.0mm Laser PMMA	Aluminum	>80	>0.9	<6	20/44	5 Years

(4) Recessed Square

Model	Diameter (MM)	Hole (MM)	Wattage +/-5%	Efficiency (LM/W)	Diffuser	LGP	Frame	CRI	PF	SDCM	IP Rating	Warranty
ZR-PL120RS-7W	120*120	105*105	7W	60	PS	3.0mm Laser PMMA	Aluminum	>80	>0.5	<6	20/44	5 Years
ZR-PL150RS-9W	148*148	128*128	9W	75	PS	3.0mm Laser PMMA	Aluminum	>80	>0.5	<6	20/44	5 Years
ZR-PL170RS-12W	170*170	150*150	12W	80	PS	3.0mm Laser PMMA	Aluminum	>80	>0.5	<6	20/44	5 Years
ZR-PL190RS-15W	190*190	170*170	15W	85	PS	3.0mm Laser PMMA	Aluminum	>80	>0.9	<6	20/44	5 Years
ZR-PL225RS-18W	220*220	200*200	18W	90	PS	3.0mm Laser PMMA	Aluminum	>80	>0.9	<6	20/44	5 Years
ZR-PL300RS-24W	300*300	280*280	24W	90	PS	3.0mm Laser PMMA	Aluminum	>80	>0.9	<6	20/44	5 Years

Installation Surface

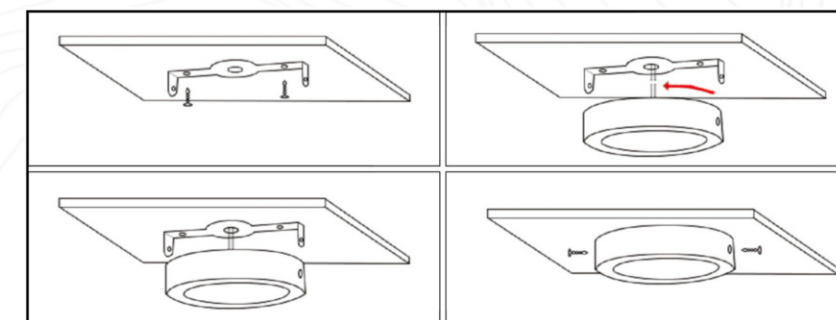

Installation Recessed

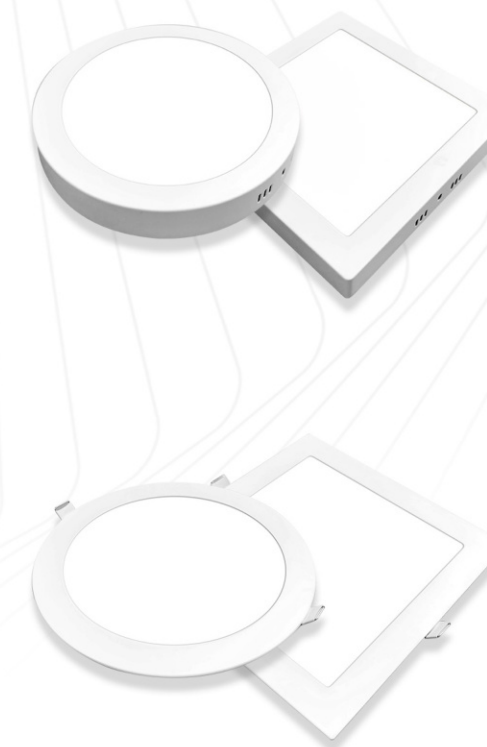
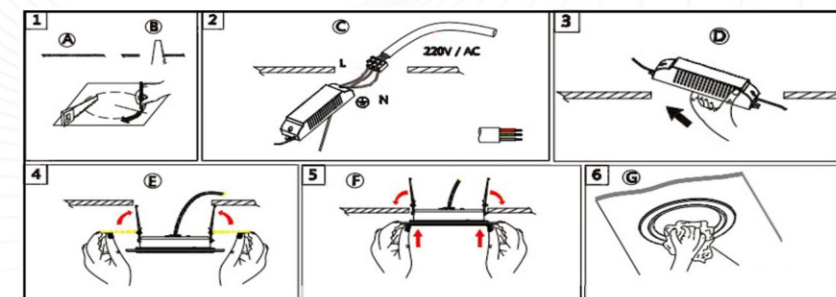

COMMERCIAL LIGHTING

Backlit Series

Merits of ZERUN Backlit Series

1

No Light Guide Plate(LGP) inside-----Simpler Item Structures, Simpler Production Procedure, Less Purchasing and Production Costs.

2

No Yellowing Any More.

3

Higher Lumens --- Backlit panels could have much higher lumens than edge-lit ones due to its structures.

4

Same Product Quality as ZERUN Edge-lit Ones.

SCREWLESS PANELS WITH SLIDEABLE NUTS

Now backlit panels with screws are playing a leading role in markets. However, to well show the differentiation from other backlit panels, ZERUN backlit screwless panel with slideable nuts is born at the right moment.



Similar to ZERUN edge-lit panels, no screws on panel body but with 4pcs L-Shaped Steel Corners Inside, so the panel frames are pretty tight and the whole panel body is pretty strong. Also, because of the screwless structures, the back plate is not strained by screws, and the whole lamp does not twist.

The panel frames are integrally extrusion formed so the straightness of panel body can be well ensured. 4 corners will not warped so there are almost no gaps between panel and ceiling after the installation.

There are slideable nuts on rear panel so it could be much easier for us to install.

Type	Regular Sizes	Wattage	Efficiency (LM/W)	Input Volts	PF	Frame	Diffuser	CRI	Single CCT Optional	SDCM	IP Rating	LED Lifespan
Indoor	595x595x26mm	40W	90-120	AC220-240V	> 0.95	Aluminum	PS	>80	3000K-6500K	< 6	20	50,000Hrs
Indoor	295x1195x26mm	40W	90-120	AC220-240V	> 0.95	Aluminum	PS	>80	3000K-6500K	< 6	20	50,000Hrs

* Customized sizes are available but MOQ is needed.

HIGH LUMENS PER WATT

Just as its name implies, this item is with high lumens per watt. For this item, it could reach about 160~170LM/W.



Type	Regular Sizes	Wattage	Efficiency (LM/W)	Input Volts	PF	Frame	Diffuser	CRI	Single CCT Optional	SDCM	IP Rating	LED Lifespan
Indoor	595x595x26mm	40W	90-160	AC220-240V	> 0.95	Aluminum	PS	>80	3000K-6500K	< 6	20	50,000Hrs

* Customized sizes are available but MOQ is needed.



LED PANEL GRILLE

The appearance of this product is very distinctive. With SMD2835 and prismatic lens, this item could be 150LM/W that high. Also, UGR could be <19 if total lumens are below 4000. This item could be well used in the area. where the ceiling is high because of its relatively small beam angle.

Type	Regular Sizes	Wattage	Efficiency (LM/W)	Input Volts	PF	Frame	Diffuser	CRI	Single CCT Optional	SDCM	IP Rating	LED Lifespan
Indoor	595x595x26mm	40W	100-150	AC220-240V	> 0.95	Aluminum	PS	>80	3000K-6500K	< 6	20	50,000Hrs
Indoor	295x1195x26mm	40W	100-150	AC220-240V	> 0.95	Aluminum	PS	>80	3000K-6500K	< 6	20	50,000Hrs

* Customized sizes are available but MOQ is needed.

* UGR values could be affected by total lumens.



Type	Regular Sizes	Wattage	Efficiency (LM/W)	Input Volts	PF	Frame	Diffuser	CRI	Single CCT Optional	SDCM	IP Rating	LED Lifespan
Indoor	595x595x18mm	40W	100-130	AC220-240V	> 0.95	Aluminum	PS	>80	3000K-6500K	< 6	20	30,000Hrs
Indoor	620x620x18mm	40W	100-130	AC220-240V	> 0.95	Aluminum	PS	>80	3000K-6500K	< 6	20	30,000Hrs



2 LINES OF GRILLE

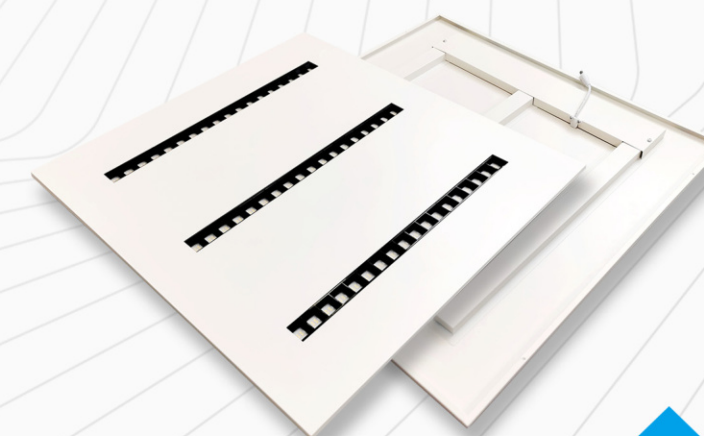

3 LINES OF GRILLE

The appearance of this item is very distinctive. With SMD2835 and prismatic lens, this item could be 130LM/W that high. Also, UGR can be <19 because of the prismatic lens.

LED CENTER BASKET TROFFER

The LED Center Basket Troffer provides an economical, easy-to-install upgrade from linear fluorescent lighting to a long-lasting and energy-efficient LED solution. The contemporary center lens design delivers a soft natural glow with even illumination making it an attractive general-purpose ambient lighting solution. Whether it's a school, hospital, airport, office, or convenience store, the recessed LED center basket troffers bring a stylish and economical lighting solution to all commercial applications.

Type	Regular Sizes	Wattage	Efficiency (LM/W)	Input Volts	PF	Housing	Diffuser	CRI	Single CCT Optional	SDCM	IP Rating	LED Lifespan
Indoor	595x595x50mm	40W	100~140	AC220-240V	> 0.95	Iron	PC	>80	3000K-6500K	< 6	20	50,000Hrs

Type	Regular Sizes	Wattage	Efficiency (LM/W)	Input Volts	PF	Housing	Diffuser	CRI	3 CCT Switchable	SDCM	IP Rating	LED Lifespan
Indoor	595x595x50mm	36W	110 Single CCT 130 Mixed CCT	AC220-240V	> 0.95	Iron	PC	>80	3000K/4500k/6500K	< 6	20	50,000Hrs

* Customized sizes are available but MOQ is needed.

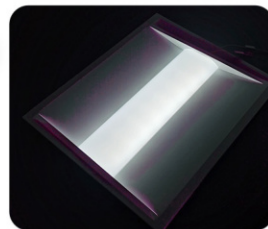

FRAME SERIES

ZERUN frame series could be pretty good replacements for LED panels and could be used in office or other places.

Type	Regular Sizes	Wattage	Efficiency (LM/W)	Input Volts	PF	Frame	Diffuser	CRI	Single CCT Optional	SDCM	IP Rating	LED Lifespan
Indoor	595x595x11mm	40W	85-100	AC220-240V	> 0.95	Aluminum	PS	>80	3000K-6500K	< 6	20	50,000Hrs

* Customized sizes are available but MOQ is needed.

Version A



Version B



Installation Instruction

Version A:

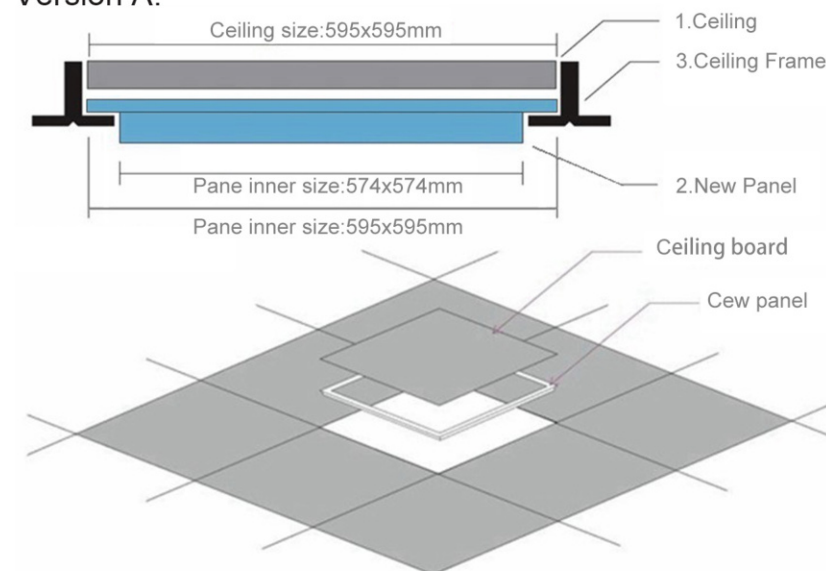

Version B:

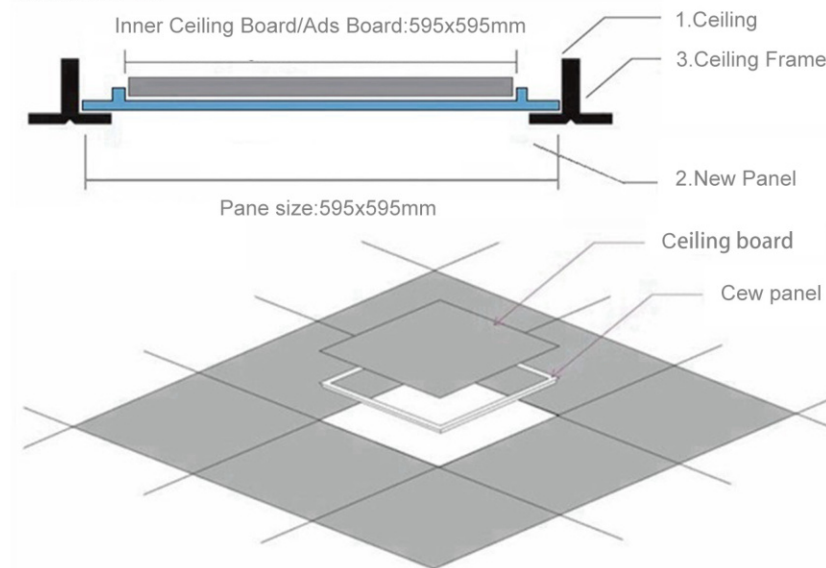

SMART HOME LIGHTING



INTERNATIONAL
DESIGN EXCELLENCE
AWARDS



DESIGN
AWARD



GOOD DESIGN
AWARD 2019



- To prevent glare
- CRI reaches 95
- Slim design
- Dust and insect prevention
- Fast installation
- Intelligent control
- Sensor design
- Emergency

INSTALLATION INSTRUCTION

1. Open the package and remove the ceiling lamp. Pull the metal chassis outward and remove it.

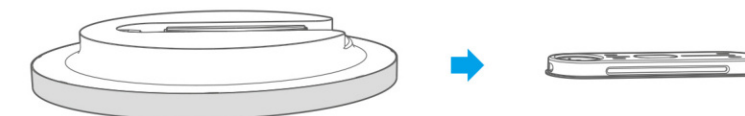

*Be sure to cut off the power before installation, and follow the instructions to install it to avoid accidents such as falling, fire and electric shock.

2. Fixed chassis

Plan A: Pass the power cord through the threading hole and fix the metal chassis to the ceiling with expansion screws and self-tapping screws to confirm that the chassis is securely installed.(priority)

Plan B: First check whether the installation point of the light box is firm. After confirming, pass the power cable through the threading hole, fix the metal chassis with screws, and confirm that the chassis is securely installed.

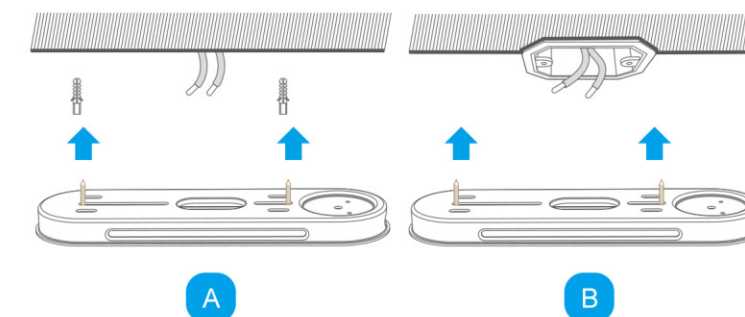

SMART HOME LIGHTING

Type	Model	Regular Sizes	Wattage	Lumens	Input Volts	PF	CRI	CCT Tunable	Dimmable	Remote	Mobile App.	Temp. Range	Humid. Range	Service Life
Surface Mounted Round	P-CH01	Φ320x45mm	24W	1300	AC220-240V	> 0.95	≥95	3000K-6500K	10%-100%	FR-2.4G	TUYA	-10℃~50℃	20%~90% RH	≥25,000Hrs
Surface Mounted Round	P-CH41	Φ420x47mm	28W	2200	AC220-240V	> 0.95	≥95	3000K-6500K	10%-100%	FR-2.4G	TUYA	-10℃~50℃	20%~90% RH	≥25,000Hrs
Surface Mounted Round	P-CH11	Φ520x41.5mm	40W	2200	AC220-240V	> 0.95	≥95	3000K-6500K	10%-100%	FR-2.4G	TUYA	-10℃~50℃	20%~90% RH	≥25,000Hrs
Surface Mounted Square	P-CH21	520x520x45.5mm	40W	2200	AC220-240V	> 0.95	≥95	3000K-6500K	10%-100%	FR-2.4G	TUYA	-10℃~50℃	20%~90% RH	≥25,000Hrs
Surface Mounted Rectangle	P-CH61	495x715x55mm	40W	3600	AC220-240V	> 0.95	≥95	3000K-6500K	10%-100%	FR-2.4G	TUYA	-10℃~50℃	20%~90% RH	≥25,000Hrs

* Single CCT versions are available.

